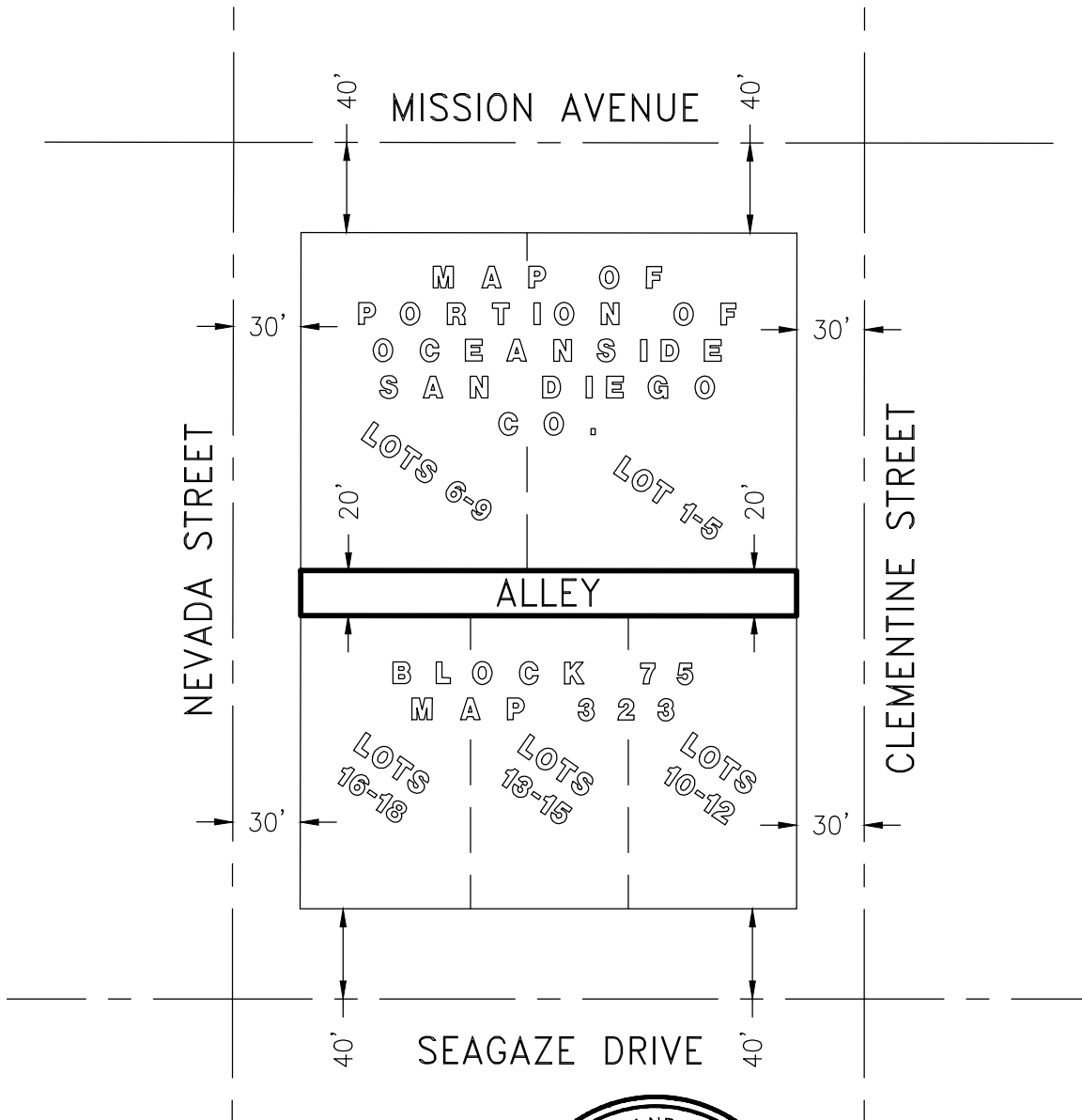
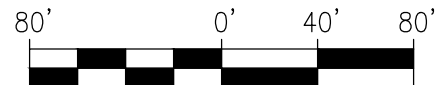
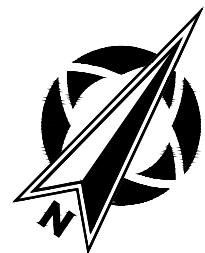

EXHIBIT "B"

PLAT TO ACCOMPANY LEGAL DESCRIPTION



11/05/2025



SCALE: 1" = 80'

AREA:

4,400 SQUARE FEET (0.101 ACRES)

LINE LEGEND:

- SUBJECT PROPERTY LINES
- CENTERLINES
- AREA DESCRIBED IN LEGAL DESCRIPTION
- ADJACENT PROPERTY LINES

FILE #

OWNER: OCEANSIDE MISSION INVESTMENTS, LLC

SITE ADDRESS: 801-815 MISSION AVENUE

ENGINEER: BRYAN SMITH

CITY OF OCEANSIDE

ENGINEERING DIVISION
**RIGHT-OF-WAY
 VACATION PLAT**

APN#

PLAN # ROWV25-00003

DATE: 11/05/2025

SHEET 1 OF 1